

- LEGEND**
- National Boundary
 - State Boundary
 - County Boundary
 - Other Boundaries
 - Delimited Area Boundary
 - Incorporated/Unincorporated Area (Additional Detail May Be Found in City Plat Book)
 - Township Line / Section Line
 - Continental Divide
 - Large River
 - Intermediate River
 - Small River
 - Intermittent Stream
 - Irrigation Canal with Flow Direction
 - Reservoir with Dam
 - Lake or Reservoir - Overflow Land
 - Marsh - Glacier
 - Elevation of Mountain Peak
 - Bladed Road
 - Graded Road - Gravel Road
 - Paved Road - Divided Highway
 - National Highway System - Interstate
 - National Highway System - Non-Interstate
 - P-31 (HS-1)
 - P-30
 - S-228
 - U-5809
 - U.S. Numbered Highway
 - Montana Route
 - Bypass / End Designated Route
 - Interchange - Grade Separation
 - Dam with Road
 - Highway Bridge - Number Closely Spaced
 - Toll Ferry - Free Ferry
 - Named Pass with Elevation
 - Railroad - Railroad with Station
 - Railroad above Grade - Railroad below Grade
 - Grade Crossing - Railroad Tunnel
 - Airport with Surfaced Runways
 - Airway Light Beacon
 - Military Field
 - Airport, Complete Facilities
 - Airfield, Limited Facilities
 - Landing Area or Strip
 - State Capitol - County Seat
 - Other Towns - Corporate Limits
 - School - Church
 - Cemetery - Cemetery with Church
 - Fort or Military Post - Courthouse
 - Post Office - U.S. Post of Entry
 - Hospital - Firestation
 - Radio Station - Industry
 - Power Plant - Power Substation
 - Sewal - Mine
 - Gas Storage Tank - Water Storage Tank
 - Picnic Grounds - Camp Grounds
 - Rest Area - Ski Area
 - Hot Spring - Triangulation Station
 - Ranger Station - Lookout Tower
 - Fairgrounds - Fish Hatchery
 - Grain Elevator - Store or County Shop

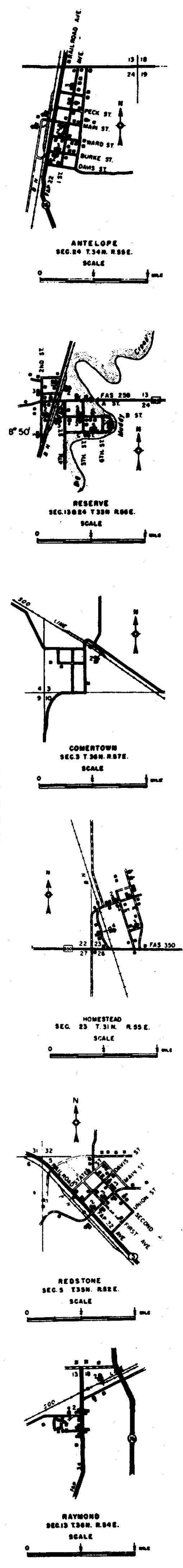
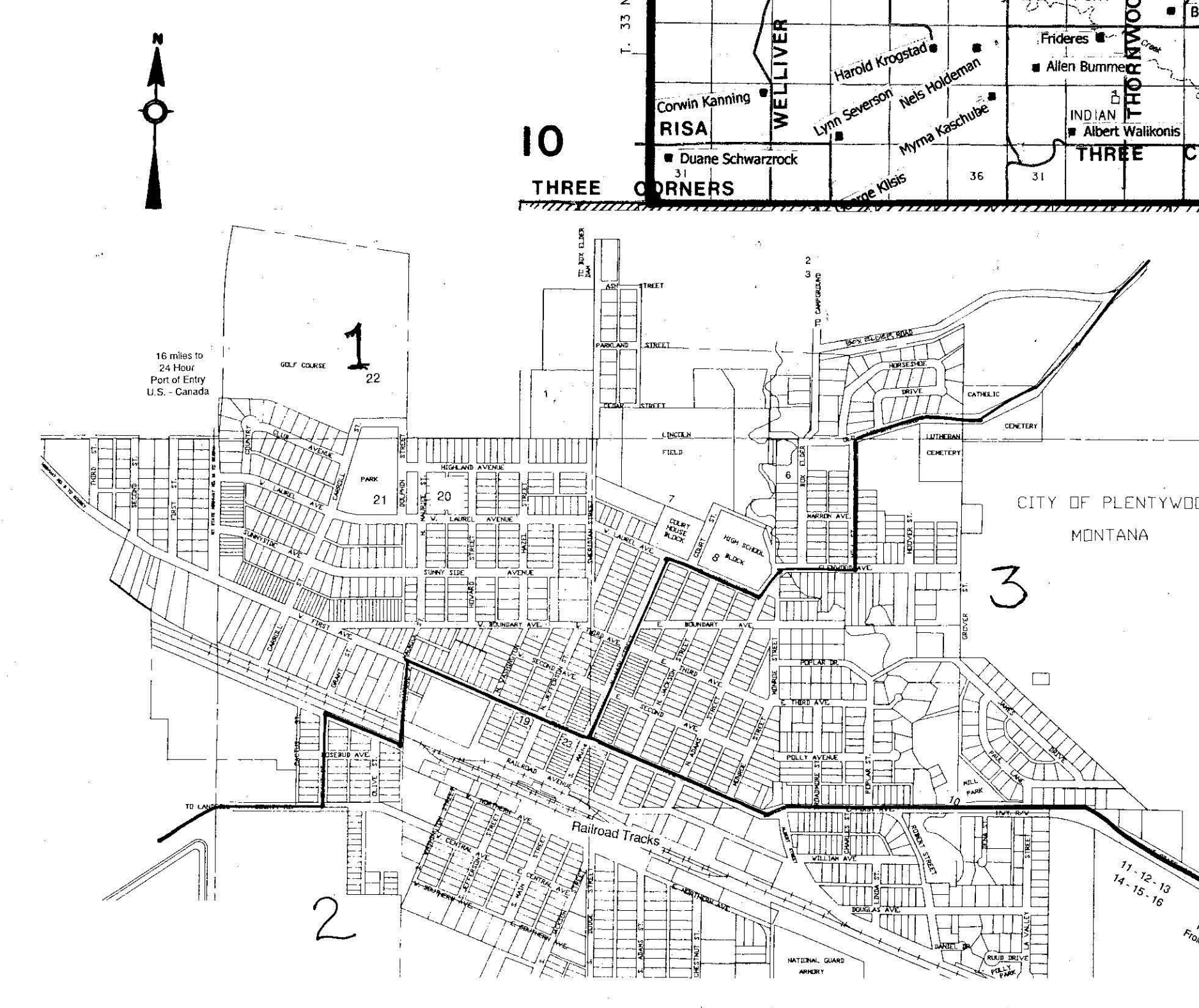
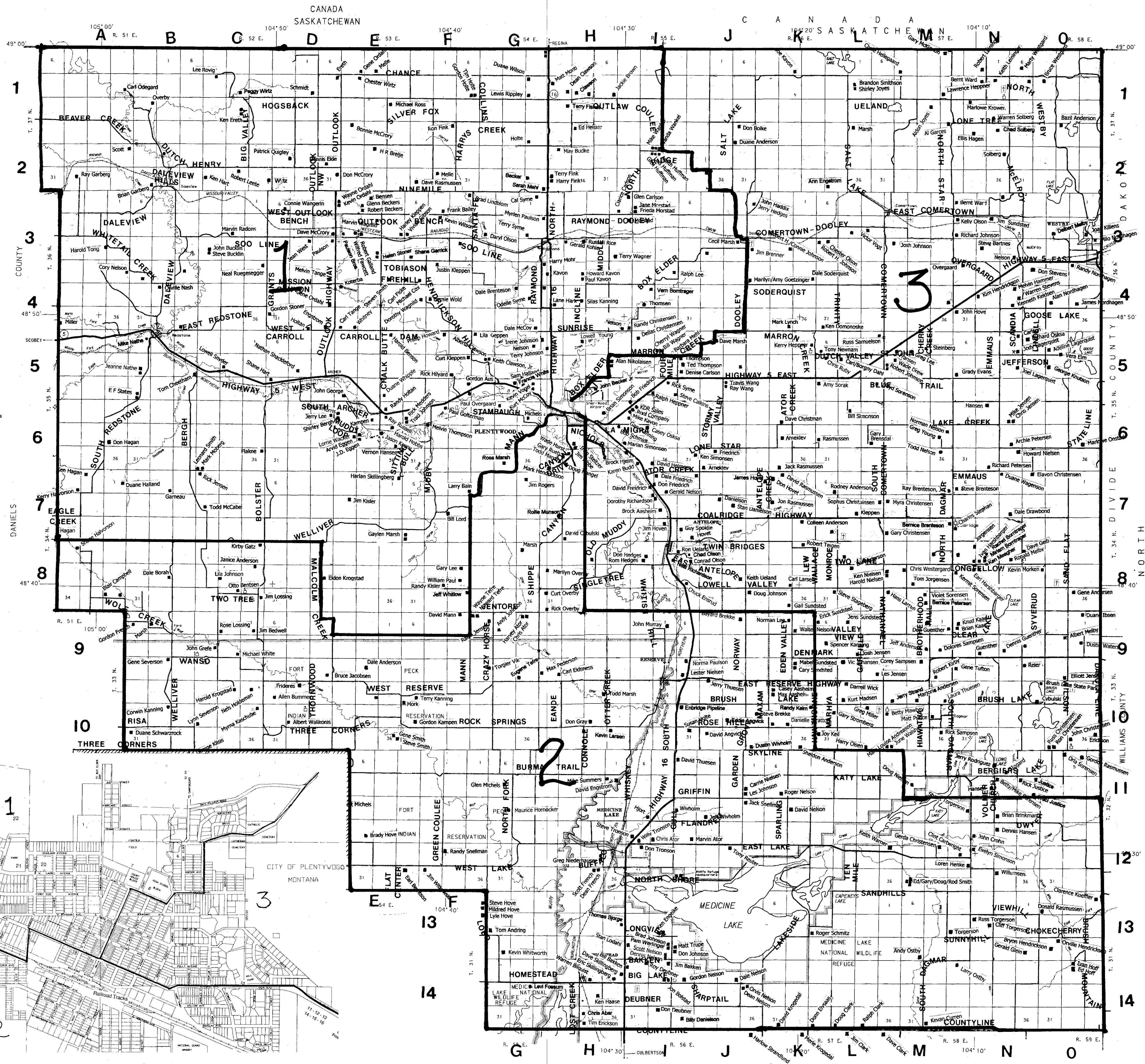

Sheridan County Commissioner Districts

- Updated July 2009 -

-realigned in 2011-